

Gas/Oil absolute pressure transmitter**FEATURES**

- ANALOG ABSOLUTE PRESSURE
- Electronic pressure sensor
- Electronic temperature sensor (optional)
- High accuracy
- IP 65 protection with cable gland
- Wide compensated temperature range
- Compatibility with corrosive fluids
- Primary element deposited on ceramic monolithic block

HIGHLIGHTS*Technical Data*

Pressure FSO range (Bar)...0 – 2; 0- 5; 0- 10; 0-20; 0-50*

Overpressure.....2X rated

Response time (10% to 90%).....5ms

Operating fluid temperature range... - 20° + 85°C

Mechanical protection of active components...IP65

Compatibility with corrosive fluids

*Versions with customized features can be provided

Performance Data

Standard pressure accuracy: <0,5% FSS

Compensated error: <0,4 % fss/10°C

Temperature accuracy: +/- 1,5°C*

Linearity error: +/- 0,2% FSS

Repeatability error: <0,1% FSS

Compensated temperature range: -20° + 85°C

Resolution: infinite

Electrical insulation: 50 Hz 1min 1,5kV

Electrical Data

Output: 4-20mA , 1-5 Vcc

Excitation: 10-35 VCC

Load: R<750ohm

Plug: DIN 43650 MPM 4 poles connector

Cable LX=1mt optional (STANDARD)

Physical descriptions

Material external: stainless steel AISI316

Material in contact with fluid: ceramic, stainless steel and EPDM

Pressure fittings: 1/4" gas male/female

Dimensions: Ø30x 40mm

Weight: 150 g

*optional



Type A transmitters are based on bridge resistance variation principle and the primary element is directly deposited on reaction mechanics by a silk screen-thick film process .

In this way the primary element can be very stable and offer the maximum protection because of monolithic ceramic block.

The innovative pressure sensor combines electronic precision with mechanical resistance for your complete safety in any conditions.

Low cost allows to use this sensor in many situation, above all in automation systems or as a supervisor for mechanical monitoring and process control.

For compatibility with most systems has ¼ gas male output fitting and is suitable for alimentary control because of the choice of material in contact with the fluid in accord with UL sanitation.

4-20mA analog output allows to get quite long distance link between sensor and remote control.

Temperature output allows to record temperature variation of device under control.

FIELD APPLICATIONS

- MV & HV oil level of transformers
- SF6 pressure inside tanks
- Gas control of automatic machinery
- Fluid controls of distribution and transmission pipes

All specs are subject to change without notice

Gas/Oil absolute pressure transmitter

Rev./Mod Descrizione:	Data	Rev./Mod Descrizione:	Data	Rev./Mod Descrizione:	Data	Rev./Mod Descrizione:	Data	Rev./Mod Descrizione:	Data
--------------------------	------	--------------------------	------	--------------------------	------	--------------------------	------	--------------------------	------

A (2 : 1)

O-RING 18.72X2.62 EPDM70PC

1/4 G MALE FITTING

LX=1mt (standard)

CH 27

NOTE :

Prep. Dis.	C. FORLANI	ELECTRONSYSTEM MD S.r.l.	Title Titolo	SGM /A/ ABS analog absolute pressure sensor
App. Dis.	P. GUZZETTI	Resp. Dep. Uff. Resp.	Approvato Approvazione	Scale 1:1
First Issue Data	05.12.2017	Doc. No. N° Doc.	43931104	

The reserve all rights in this document and in the information contained therein. Reproduction, use or disclosure to third parties without express authority is strictly forbidden. We reserve also the rights to modify the drawing without notice. C:\Reserve\MD\IT\GSM\GSM_SGM_S.r.l. presente documento e con l'articolo 9 lo modulo in rappresentanza del gruppo di produzione. Il presente documento è con l'articolo 9 lo modulo in rappresentanza del gruppo di produzione. Il presente documento è con l'articolo 9 lo modulo in rappresentanza del gruppo di produzione.

All specs are subject to change without notice

Gas/Oil absolute pressure transmitter

Rev./Mod	Data	Rev./Mod	Data	Rev./Mod	Data	Rev./Mod	Data
Descrizione:		Descrizione:		Descrizione:		Descrizione:	
<p>1/4 G FEMALE FITTING</p>							

NOTE :

O-RING 18.72X2.62 EPDM70PC

Prep. Dis. C. FORLANI	ELECTRONSYSTEM MD S.r.l.	Resp. Dep. Technical Dept.	Title Triolo Apporcius Apperchio	Doc. No. In Doc. 43931104
App. P. GUIZZETTI		First Issue: 05.12.2017	Scale 1:1	Scale 1:1

We reserve all rights in this document and in the information contained therein. Reproduction, use or disclosure to third parties without express authority is strictly forbidden. We reserve also the rights to modify the drawing without notice. Ci riserviamo tutti i diritti connessi con il presente documento e con l'oggetto o la materia in rappresentati con divieto di riproduzione, utilizzazione o rendere accessibile o terzi in assenza di previa autorizzazione. Ci riserviamo anche i diritti di modificare il disegno senza preavviso.

All specs are subject to change without notice

Gas/Oil absolute pressure transmitter

Rev./Mod	Data	Rev./Mod	Data	Rev./Mod	Data	Rev./Mod	Data
Descrizione:		Descrizione:		Descrizione:		Descrizione:	
Prep. Dis. C. FORLANI App. P. GIUZZETTI		ELECTRONSYSTEM MD S.r.l.		Resp. Dep. Technical Dept. Uff. Resp.		Title SGM/A/ABS analog Apparatus absolute pressure sensor N° Doc. 43931104	
NOTE :						Scale 1:1 Scale 1:1	

We reserve all rights in this document and in the information contained therein. Reproduction, use or disclosure to third parties without express authority is strictly forbidden. We reserve also the rights to modify the drawing without notice. Ci riserviamo tutti i diritti connessi con il presente documento e con l'oggetto e lo materia ivi rappresentati con divieto di riproduzione, utilizzo o renderlo accessibile a terzi in assenza di previa autorizzazione. Ci riserviamo anche i diritti di modificare il disegno senza preavviso.

All specs are subject to change without notice

Gas/Oil absolute pressure transmitter

Rev./Mod	Data	Rev./Mod	Data	Rev./Mod	Data	Rev./Mod	Data	Rev./Mod	Data	Rev./Mod	Data																																	
Descrizione:		Descrizione:		Descrizione:		Descrizione:		Descrizione:		Descrizione:																																		
<p>ORDERING CODE:</p> <p>Code : SGM/A/ABS/ / / / /</p> <p>C : with cable, lenght 1mt CS : with cable, lenght 5mt</p> <p>M : mole 1/4" gos 12M : mole 1/2" gos F : femole 1/4" gos</p> <p>V : voltare output A : current output</p> <p>02 : 2 Bar 05 : 5 Bar 10 : 10 Bar 20 : 20 Bar 50 : 50 Bar</p> <table border="1"> <thead> <tr> <th>CODE</th> <th>FULL SPAN</th> <th>OUTPUT</th> </tr> </thead> <tbody> <tr> <td>SGM/A/ABS/2A</td> <td>2 Bar</td> <td>4-20mA</td> </tr> <tr> <td>SGM/A/ABS/5A</td> <td>5 Bar</td> <td>4-20mA</td> </tr> <tr> <td>SGM/A/ABS/10A</td> <td>10 Bar</td> <td>4-20mA</td> </tr> <tr> <td>SGM/A/ABS/20A</td> <td>20 Bar</td> <td>4-20mA</td> </tr> <tr> <td>SGM/A/ABS/50A</td> <td>50 Bar</td> <td>4-20mA</td> </tr> <tr> <td>SGM/A/ABS/2V</td> <td>2 Bar</td> <td>1-5 Vcc</td> </tr> <tr> <td>SGM/A/ABS/5V</td> <td>5 Bar</td> <td>1-5 Vcc</td> </tr> <tr> <td>SGM/A/ABS/10V</td> <td>10 Bar</td> <td>1-5 Vcc</td> </tr> <tr> <td>SGM/A/ABS/20V</td> <td>20 Bar</td> <td>1-5 Vcc</td> </tr> <tr> <td>SGM/A/ABS/50V</td> <td>50 Bar</td> <td>1-5 Vcc</td> </tr> </tbody> </table> <p>VOLTAGE CURRENT</p> <div style="display: flex; justify-content: space-around;"> <div style="text-align: center;"> <p>SGM/A/XV CURRENT OUTPUT</p> </div> <div style="text-align: center;"> <p>SGM/A/XV VOLTAGE OUTPUT (& temperature sensor*)</p> <p>*optional</p> </div> </div>												CODE	FULL SPAN	OUTPUT	SGM/A/ABS/2A	2 Bar	4-20mA	SGM/A/ABS/5A	5 Bar	4-20mA	SGM/A/ABS/10A	10 Bar	4-20mA	SGM/A/ABS/20A	20 Bar	4-20mA	SGM/A/ABS/50A	50 Bar	4-20mA	SGM/A/ABS/2V	2 Bar	1-5 Vcc	SGM/A/ABS/5V	5 Bar	1-5 Vcc	SGM/A/ABS/10V	10 Bar	1-5 Vcc	SGM/A/ABS/20V	20 Bar	1-5 Vcc	SGM/A/ABS/50V	50 Bar	1-5 Vcc
CODE	FULL SPAN	OUTPUT																																										
SGM/A/ABS/2A	2 Bar	4-20mA																																										
SGM/A/ABS/5A	5 Bar	4-20mA																																										
SGM/A/ABS/10A	10 Bar	4-20mA																																										
SGM/A/ABS/20A	20 Bar	4-20mA																																										
SGM/A/ABS/50A	50 Bar	4-20mA																																										
SGM/A/ABS/2V	2 Bar	1-5 Vcc																																										
SGM/A/ABS/5V	5 Bar	1-5 Vcc																																										
SGM/A/ABS/10V	10 Bar	1-5 Vcc																																										
SGM/A/ABS/20V	20 Bar	1-5 Vcc																																										
SGM/A/ABS/50V	50 Bar	1-5 Vcc																																										
<table border="1"> <tr> <td>Prep. Dis:</td> <td>G. FORLANI</td> <td rowspan="3" style="text-align: center; vertical-align: middle;">ELECTRONSYSTEM MD S.r.l.</td> <td rowspan="3" style="text-align: center; vertical-align: middle;">SGM/A/ABS analog absolute pressure sensor</td> <td rowspan="3" style="text-align: center; vertical-align: middle;">Scale 1:1</td> </tr> <tr> <td>App. P.:</td> <td>CUZZETTI</td> </tr> <tr> <td>First Issue:</td> <td>05.12.2017</td> </tr> <tr> <td>Resp. Dep. Uff. Resp.:</td> <td>Technical Dept.</td> <td>Title</td> <td>Apparatus Apporecchio</td> <td>Doc. No.</td> </tr> <tr> <td>NOTE :</td> <td></td> <td>43931104</td> <td></td> <td></td> </tr> </table>												Prep. Dis:	G. FORLANI	ELECTRONSYSTEM MD S.r.l.	SGM/A/ABS analog absolute pressure sensor	Scale 1:1	App. P.:	CUZZETTI	First Issue:	05.12.2017	Resp. Dep. Uff. Resp.:	Technical Dept.	Title	Apparatus Apporecchio	Doc. No.	NOTE :		43931104																
Prep. Dis:	G. FORLANI	ELECTRONSYSTEM MD S.r.l.	SGM/A/ABS analog absolute pressure sensor	Scale 1:1																																								
App. P.:	CUZZETTI																																											
First Issue:	05.12.2017																																											
Resp. Dep. Uff. Resp.:	Technical Dept.	Title	Apparatus Apporecchio	Doc. No.																																								
NOTE :		43931104																																										

All specs are subject to change without notice

Gas/Oil absolute pressure transmitter

Rev./Mod Descrizione:		Rev./Mod Descrizione:		Rev./Mod Descrizione:		Rev./Mod Descrizione:		Rev./Mod Descrizione:		Rev./Mod Descrizione:																																																																																																																																																																																																																																																																																																																																																																																																																																					
Date		Date		Date		Date		Date		Date																																																																																																																																																																																																																																																																																																																																																																																																																																					
Chemical Material Compatibility																																																																																																																																																																																																																																																																																																																																																																																																																																															
<p>Chemical</p> <table border="1"> <thead> <tr> <th>CHEMICAL</th> <th>COMPATIBILITY</th> <th>CHEMICAL</th> <th>COMPATIBILITY</th> <th>CHEMICAL</th> <th>COMPATIBILITY</th> <th>CHEMICAL</th> <th>COMPATIBILITY</th> <th>CHEMICAL</th> <th>COMPATIBILITY</th> <th>CHEMICAL</th> <th>COMPATIBILITY</th> </tr> </thead> <tbody> <tr><td>Acetic Acid</td><td>A - Excellent</td><td>Carbon Dioxide (wet)</td><td>A - Excellent</td><td>Magnesium Hydroxide</td><td>A - Excellent</td><td>Propylene Glycol</td><td>A - Excellent</td></tr> <tr><td>Acetic Acid 20%</td><td>A - Excellent</td><td>Carbon Tetrachloride</td><td>A - Excellent</td><td>Magnesium Nitrate</td><td>A - Excellent</td><td>Pyridine</td><td>A - Excellent</td></tr> <tr><td>Acetic Acid 80%</td><td>A - Excellent</td><td>Carbon Tetrachloride (dry)</td><td>A - Excellent</td><td>Manganese Sulfate</td><td>A - Excellent</td><td>Saag Solutions</td><td>A - Excellent</td></tr> <tr><td>Acetic Acid, Glycerol</td><td>A - Excellent</td><td>Carbon tetrachloride (wet)</td><td>A - Excellent</td><td>Mercuric Chloride (dilute)</td><td>A - Excellent</td><td>Sodium Acetate</td><td>A - Excellent</td></tr> <tr><td>Acetic Anhydride</td><td>A - Excellent</td><td>Chloroform</td><td>A - Excellent</td><td>Mercuric Cyanide</td><td>A - Excellent</td><td>Sodium Bicarbonate</td><td>A - Excellent</td></tr> <tr><td>Acetone</td><td>A - Excellent</td><td>Chlorine Water</td><td>A - Excellent</td><td>Mercurous Nitrate</td><td>A - Excellent</td><td>Sodium Bisulfite</td><td>A - Excellent</td></tr> <tr><td>Alcohols: Amyl</td><td>A - Excellent</td><td>Chlorobenzene (Mono)</td><td>A - Excellent</td><td>Mercury</td><td>A - Excellent</td><td>Sodium Bisulfate</td><td>A - Excellent</td></tr> <tr><td>Alcohols: Benzyl</td><td>A - Excellent</td><td>Chlorobromomethane</td><td>A - Excellent</td><td>Methanol (Methyl Alcohol)</td><td>A - Excellent</td><td>Sodium Borate (borax)</td><td>A - Excellent</td></tr> <tr><td>Alcohols: Butyl</td><td>A - Excellent</td><td>Chloroform</td><td>A - Excellent</td><td>Methyl Alcohol 10%</td><td>A - Excellent</td><td>Sodium Carbonate</td><td>A - Excellent</td></tr> <tr><td>Alcohols: Ethyl</td><td>A - Excellent</td><td>Chlorosulfonic Acid</td><td>A - Excellent</td><td>Methyl Ethyl ketone</td><td>A - Excellent</td><td>Sodium Chloride</td><td>A - Excellent</td></tr> <tr><td>Alcohols: Isopropyl</td><td>A - Excellent</td><td>Citronic Acid 10%</td><td>A - Excellent</td><td>Milk</td><td>A - Excellent</td><td>Sodium Chloride</td><td>A - Excellent</td></tr> <tr><td>Alcohols: Methyl</td><td>A - Excellent</td><td>Citronic Acid 30%</td><td>A - Excellent</td><td>Molasses</td><td>A - Excellent</td><td>Sodium Cyanide</td><td>A - Excellent</td></tr> <tr><td>Alcohols: Propyl</td><td>A - Excellent</td><td>Citronic Acid 50%</td><td>A - Excellent</td><td>Motor oil</td><td>A - Excellent</td><td>Sodium Ferricyanide</td><td>A - Excellent</td></tr> <tr><td>Aluminum Chloride</td><td>A - Excellent</td><td>Citric Acid</td><td>A - Excellent</td><td>Naphthalene</td><td>A - Excellent</td><td>Sodium Fluoride</td><td>A - Excellent</td></tr> <tr><td>Aluminum Chloride 20%</td><td>A - Excellent</td><td>Cider</td><td>A - Excellent</td><td>Nickel Chloride</td><td>A - Excellent</td><td>Sodium Hydroxide (20%)</td><td>A - Excellent</td></tr> <tr><td>Aluminum Sulfate</td><td>A - Excellent</td><td>Citric Acid 50%</td><td>A - Excellent</td><td>Nickel Nitrate</td><td>A - Excellent</td><td>Sodium Hydroxide (50%)</td><td>A - Excellent</td></tr> <tr><td>Ammonia 10%</td><td>A - Excellent</td><td>Copper Chloride</td><td>A - Excellent</td><td>Nickel Sulfate</td><td>A - Excellent</td><td>Sodium Hydroxide (80%)</td><td>A - Excellent</td></tr> <tr><td>Ammonia liquid</td><td>A - Excellent</td><td>Copper Oxide</td><td>A - Excellent</td><td>Nitric Acid (20%)</td><td>A - Excellent</td><td>Sodium Hypochlorite (<20%)</td><td>A - Excellent</td></tr> <tr><td>Ammonium Carbonate</td><td>A - Excellent</td><td>Copper Nitrate</td><td>A - Excellent</td><td>Nitric Acid (50%)</td><td>A - Excellent</td><td>Sodium Hypochlorite (100%)</td><td>A - Excellent</td></tr> <tr><td>Ammonium Chloride</td><td>A - Excellent</td><td>Copper Sulfate 5%</td><td>A - Excellent</td><td>Nitric Acid (6-10%)</td><td>A - Excellent</td><td>Sodium Nitrate</td><td>A - Excellent</td></tr> <tr><td>Ammonium Hydroxide</td><td>A - Excellent</td><td>Crotonaldehyde</td><td>A - Excellent</td><td>Nitric Acid (concentrated)</td><td>A - Excellent</td><td>Sodium Sulfate</td><td>A - Excellent</td></tr> <tr><td>Ammonium Nitrate</td><td>A - Excellent</td><td>Dietergents</td><td>A - Excellent</td><td>Oil: Castor</td><td>A - Excellent</td><td>Sodium Sulfate</td><td>A - Excellent</td></tr> <tr><td>Ammonium Persulfate</td><td>A - Excellent</td><td>Dichloroethane</td><td>A - Excellent</td><td>Oil: Cottonseed</td><td>A - Excellent</td><td>Sodium Sulfide</td><td>A - Excellent</td></tr> <tr><td>Ammonium Sulfate</td><td>A - Excellent</td><td>Ethanol</td><td>A - Excellent</td><td>Oil: Linseed</td><td>A - Excellent</td><td>Stannic Chloride</td><td>A - Excellent</td></tr> <tr><td>Amyl Acetate</td><td>A - Excellent</td><td>Ethanolamine</td><td>A - Excellent</td><td>Oil: Mineral</td><td>A - Excellent</td><td>Starch</td><td>A - Excellent</td></tr> <tr><td>Amyl Alcohol</td><td>A - Excellent</td><td>Ethyl Acetate</td><td>A - Excellent</td><td>Oil: Olive</td><td>A - Excellent</td><td>Sulfuric Acid (<10%)</td><td>A - Excellent</td></tr> <tr><td>Aniline</td><td>A - Excellent</td><td>Ethyl Chloride</td><td>A - Excellent</td><td>Oleic Acid</td><td>A - Excellent</td><td>Sulfuric Acid (10-25%)</td><td>A - Excellent</td></tr> <tr><td>Antimony Trichloride</td><td>A - Excellent</td><td>Ethylene Dichloride</td><td>A - Excellent</td><td>Oxalic Acid (cold)</td><td>A - Excellent</td><td>Sulfuric Acid (75-100%)</td><td>A - Excellent</td></tr> <tr><td>Antimony Trichloride</td><td>B - Good</td><td>Ethylene Glycol</td><td>A - Excellent</td><td>Paraffin</td><td>A - Excellent</td><td>Sulfuric Acid (hot concentrated)</td><td>A - Excellent</td></tr> <tr><td>Barium Carbonate</td><td>A - Excellent</td><td>Fatty Acids</td><td>A - Excellent</td><td>Perchloroethylene</td><td>A - Excellent</td><td>Tannic Acid</td><td>A - Excellent</td></tr> <tr><td>Barium Chloride</td><td>A - Excellent</td><td>Ferric Sulfate</td><td>A - Excellent</td><td>Phenol (10%)</td><td>A - Excellent</td><td>Tartaric Acid</td><td>A - Excellent</td></tr> <tr><td>Barium Chloride</td><td>A - Excellent</td><td>Ferrous Sulfate</td><td>A - Excellent</td><td>Phenol (Carbolic Acid)</td><td>A - Excellent</td><td>Tertbutyl Alcohol</td><td>A - Excellent</td></tr> <tr><td>Barium Hydroxide</td><td>A - Excellent</td><td>Ferrous Sulfate</td><td>A - Excellent</td><td>Phosphoric Acid (<30%)</td><td>A - Excellent</td><td>Tetralin</td><td>A - Excellent</td></tr> <tr><td>Barium Sulfate</td><td>A - Excellent</td><td>Freon 113</td><td>A - Excellent</td><td>Phosphoric Acid (>30%)</td><td>A - Excellent</td><td>Toluene (Toluol)</td><td>A - Excellent</td></tr> <tr><td>Barium Sulfide</td><td>A - Excellent</td><td>Freon TF</td><td>A - Excellent</td><td>Phosphoric Acid (>90%)</td><td>A - Excellent</td><td>Trichloroethylene</td><td>A - Excellent</td></tr> <tr><td>Benzaldehyde</td><td>A - Excellent</td><td>Freon 11</td><td>A - Excellent</td><td>Phosphoric Acid (>90%)</td><td>A - Excellent</td><td>Triethyleneglycol</td><td>A - Excellent</td></tr> <tr><td>Benzene</td><td>A - Excellent</td><td>Fruit Juice</td><td>A - Excellent</td><td>Phosphoric Acid (>90%)</td><td>A - Excellent</td><td>Trimethylamine</td><td>A - Excellent</td></tr> <tr><td>Benzene Sulfonic Acid</td><td>A - Excellent</td><td>Gasoline (High aromatic)</td><td>A - Excellent</td><td>Phosphoric Acid (>90%)</td><td>A - Excellent</td><td>Tripropylene Glycol</td><td>A - Excellent</td></tr> <tr><td>Benzonic Acid</td><td>A - Excellent</td><td>Gasoline, leaded, ref</td><td>A - Excellent</td><td>Phosphoric Acid (>90%)</td><td>A - Excellent</td><td>Urea</td><td>B - Good</td></tr> <tr><td>Benzol</td><td>A - Excellent</td><td>Glycerin</td><td>A - Excellent</td><td>Phosphoric Acid (>90%)</td><td>A - Excellent</td><td>Vegetable Juice</td><td>A - Excellent</td></tr> <tr><td>Boric Acid</td><td>A - Excellent</td><td>Hydrogen Peroxide 100%</td><td>A - Excellent</td><td>Phosphoric Acid (>90%)</td><td>A - Excellent</td><td>Vinagar</td><td>A - Excellent</td></tr> <tr><td>Bromine</td><td>A - Excellent</td><td>Hydrogen Sulfide (aque)</td><td>A - Excellent</td><td>Phosphoric Acid (>90%)</td><td>A - Excellent</td><td>Vinyl Acetate</td><td>A - Excellent</td></tr> <tr><td>Calcium Carbonate</td><td>A - Excellent</td><td>Ink</td><td>A - Excellent</td><td>Phosphoric Acid (>90%)</td><td>A - Excellent</td><td>Vinyl Chloride</td><td>B - Good</td></tr> <tr><td>Calcium Chloride</td><td>A - Excellent</td><td>Kerosene</td><td>A - Excellent</td><td>Phosphoric Acid (>90%)</td><td>A - Excellent</td><td>Water Acid Mine</td><td>A - Excellent</td></tr> <tr><td>Calcium Hydroxide</td><td>A - Excellent</td><td>Lactic Acid</td><td>A - Excellent</td><td>Phosphoric Acid (>90%)</td><td>A - Excellent</td><td>Water/ Deionized</td><td>B - Good</td></tr> <tr><td>Calcium Hydrochloride</td><td>A - Excellent</td><td>Lead Acetate</td><td>A - Excellent</td><td>Phosphoric Acid (>90%)</td><td>A - Excellent</td><td>Water/ Fresh</td><td>A - Excellent</td></tr> <tr><td>Calcium Nitrate</td><td>A - Excellent</td><td>LiAlH₄</td><td>A - Excellent</td><td>Phosphoric Acid (>90%)</td><td>A - Excellent</td><td>Water/ Salt</td><td>B - Good</td></tr> <tr><td>Calcium Sulfate</td><td>A - Excellent</td><td>Lye: Ca(OH)₂ Calcium Hydroxide</td><td>A - Excellent</td><td>Phosphoric Acid (>90%)</td><td>A - Excellent</td><td>Wheat Killers</td><td>B - Good</td></tr> <tr><td>Carbolic Acid (Phenol)</td><td>A - Excellent</td><td>Lye: NaOH Sodium Hydroxide</td><td>A - Excellent</td><td>Phosphoric Acid (>90%)</td><td>A - Excellent</td><td>Whiskey & Wines</td><td>A - Excellent</td></tr> <tr><td></td><td></td><td>Magnesium Carbonate</td><td>A - Excellent</td><td></td><td></td><td>Xylene</td><td>A - Excellent</td></tr> <tr><td></td><td></td><td>Magnesium Chloride</td><td>A2 - Excellent</td><td></td><td></td><td></td><td></td></tr> </tbody> </table>												CHEMICAL	COMPATIBILITY	CHEMICAL	COMPATIBILITY	CHEMICAL	COMPATIBILITY	CHEMICAL	COMPATIBILITY	CHEMICAL	COMPATIBILITY	CHEMICAL	COMPATIBILITY	Acetic Acid	A - Excellent	Carbon Dioxide (wet)	A - Excellent	Magnesium Hydroxide	A - Excellent	Propylene Glycol	A - Excellent	Acetic Acid 20%	A - Excellent	Carbon Tetrachloride	A - Excellent	Magnesium Nitrate	A - Excellent	Pyridine	A - Excellent	Acetic Acid 80%	A - Excellent	Carbon Tetrachloride (dry)	A - Excellent	Manganese Sulfate	A - Excellent	Saag Solutions	A - Excellent	Acetic Acid, Glycerol	A - Excellent	Carbon tetrachloride (wet)	A - Excellent	Mercuric Chloride (dilute)	A - Excellent	Sodium Acetate	A - Excellent	Acetic Anhydride	A - Excellent	Chloroform	A - Excellent	Mercuric Cyanide	A - Excellent	Sodium Bicarbonate	A - Excellent	Acetone	A - Excellent	Chlorine Water	A - Excellent	Mercurous Nitrate	A - Excellent	Sodium Bisulfite	A - Excellent	Alcohols: Amyl	A - Excellent	Chlorobenzene (Mono)	A - Excellent	Mercury	A - Excellent	Sodium Bisulfate	A - Excellent	Alcohols: Benzyl	A - Excellent	Chlorobromomethane	A - Excellent	Methanol (Methyl Alcohol)	A - Excellent	Sodium Borate (borax)	A - Excellent	Alcohols: Butyl	A - Excellent	Chloroform	A - Excellent	Methyl Alcohol 10%	A - Excellent	Sodium Carbonate	A - Excellent	Alcohols: Ethyl	A - Excellent	Chlorosulfonic Acid	A - Excellent	Methyl Ethyl ketone	A - Excellent	Sodium Chloride	A - Excellent	Alcohols: Isopropyl	A - Excellent	Citronic Acid 10%	A - Excellent	Milk	A - Excellent	Sodium Chloride	A - Excellent	Alcohols: Methyl	A - Excellent	Citronic Acid 30%	A - Excellent	Molasses	A - Excellent	Sodium Cyanide	A - Excellent	Alcohols: Propyl	A - Excellent	Citronic Acid 50%	A - Excellent	Motor oil	A - Excellent	Sodium Ferricyanide	A - Excellent	Aluminum Chloride	A - Excellent	Citric Acid	A - Excellent	Naphthalene	A - Excellent	Sodium Fluoride	A - Excellent	Aluminum Chloride 20%	A - Excellent	Cider	A - Excellent	Nickel Chloride	A - Excellent	Sodium Hydroxide (20%)	A - Excellent	Aluminum Sulfate	A - Excellent	Citric Acid 50%	A - Excellent	Nickel Nitrate	A - Excellent	Sodium Hydroxide (50%)	A - Excellent	Ammonia 10%	A - Excellent	Copper Chloride	A - Excellent	Nickel Sulfate	A - Excellent	Sodium Hydroxide (80%)	A - Excellent	Ammonia liquid	A - Excellent	Copper Oxide	A - Excellent	Nitric Acid (20%)	A - Excellent	Sodium Hypochlorite (<20%)	A - Excellent	Ammonium Carbonate	A - Excellent	Copper Nitrate	A - Excellent	Nitric Acid (50%)	A - Excellent	Sodium Hypochlorite (100%)	A - Excellent	Ammonium Chloride	A - Excellent	Copper Sulfate 5%	A - Excellent	Nitric Acid (6-10%)	A - Excellent	Sodium Nitrate	A - Excellent	Ammonium Hydroxide	A - Excellent	Crotonaldehyde	A - Excellent	Nitric Acid (concentrated)	A - Excellent	Sodium Sulfate	A - Excellent	Ammonium Nitrate	A - Excellent	Dietergents	A - Excellent	Oil: Castor	A - Excellent	Sodium Sulfate	A - Excellent	Ammonium Persulfate	A - Excellent	Dichloroethane	A - Excellent	Oil: Cottonseed	A - Excellent	Sodium Sulfide	A - Excellent	Ammonium Sulfate	A - Excellent	Ethanol	A - Excellent	Oil: Linseed	A - Excellent	Stannic Chloride	A - Excellent	Amyl Acetate	A - Excellent	Ethanolamine	A - Excellent	Oil: Mineral	A - Excellent	Starch	A - Excellent	Amyl Alcohol	A - Excellent	Ethyl Acetate	A - Excellent	Oil: Olive	A - Excellent	Sulfuric Acid (<10%)	A - Excellent	Aniline	A - Excellent	Ethyl Chloride	A - Excellent	Oleic Acid	A - Excellent	Sulfuric Acid (10-25%)	A - Excellent	Antimony Trichloride	A - Excellent	Ethylene Dichloride	A - Excellent	Oxalic Acid (cold)	A - Excellent	Sulfuric Acid (75-100%)	A - Excellent	Antimony Trichloride	B - Good	Ethylene Glycol	A - Excellent	Paraffin	A - Excellent	Sulfuric Acid (hot concentrated)	A - Excellent	Barium Carbonate	A - Excellent	Fatty Acids	A - Excellent	Perchloroethylene	A - Excellent	Tannic Acid	A - Excellent	Barium Chloride	A - Excellent	Ferric Sulfate	A - Excellent	Phenol (10%)	A - Excellent	Tartaric Acid	A - Excellent	Barium Chloride	A - Excellent	Ferrous Sulfate	A - Excellent	Phenol (Carbolic Acid)	A - Excellent	Tertbutyl Alcohol	A - Excellent	Barium Hydroxide	A - Excellent	Ferrous Sulfate	A - Excellent	Phosphoric Acid (<30%)	A - Excellent	Tetralin	A - Excellent	Barium Sulfate	A - Excellent	Freon 113	A - Excellent	Phosphoric Acid (>30%)	A - Excellent	Toluene (Toluol)	A - Excellent	Barium Sulfide	A - Excellent	Freon TF	A - Excellent	Phosphoric Acid (>90%)	A - Excellent	Trichloroethylene	A - Excellent	Benzaldehyde	A - Excellent	Freon 11	A - Excellent	Phosphoric Acid (>90%)	A - Excellent	Triethyleneglycol	A - Excellent	Benzene	A - Excellent	Fruit Juice	A - Excellent	Phosphoric Acid (>90%)	A - Excellent	Trimethylamine	A - Excellent	Benzene Sulfonic Acid	A - Excellent	Gasoline (High aromatic)	A - Excellent	Phosphoric Acid (>90%)	A - Excellent	Tripropylene Glycol	A - Excellent	Benzonic Acid	A - Excellent	Gasoline, leaded, ref	A - Excellent	Phosphoric Acid (>90%)	A - Excellent	Urea	B - Good	Benzol	A - Excellent	Glycerin	A - Excellent	Phosphoric Acid (>90%)	A - Excellent	Vegetable Juice	A - Excellent	Boric Acid	A - Excellent	Hydrogen Peroxide 100%	A - Excellent	Phosphoric Acid (>90%)	A - Excellent	Vinagar	A - Excellent	Bromine	A - Excellent	Hydrogen Sulfide (aque)	A - Excellent	Phosphoric Acid (>90%)	A - Excellent	Vinyl Acetate	A - Excellent	Calcium Carbonate	A - Excellent	Ink	A - Excellent	Phosphoric Acid (>90%)	A - Excellent	Vinyl Chloride	B - Good	Calcium Chloride	A - Excellent	Kerosene	A - Excellent	Phosphoric Acid (>90%)	A - Excellent	Water Acid Mine	A - Excellent	Calcium Hydroxide	A - Excellent	Lactic Acid	A - Excellent	Phosphoric Acid (>90%)	A - Excellent	Water/ Deionized	B - Good	Calcium Hydrochloride	A - Excellent	Lead Acetate	A - Excellent	Phosphoric Acid (>90%)	A - Excellent	Water/ Fresh	A - Excellent	Calcium Nitrate	A - Excellent	LiAlH ₄	A - Excellent	Phosphoric Acid (>90%)	A - Excellent	Water/ Salt	B - Good	Calcium Sulfate	A - Excellent	Lye: Ca(OH) ₂ Calcium Hydroxide	A - Excellent	Phosphoric Acid (>90%)	A - Excellent	Wheat Killers	B - Good	Carbolic Acid (Phenol)	A - Excellent	Lye: NaOH Sodium Hydroxide	A - Excellent	Phosphoric Acid (>90%)	A - Excellent	Whiskey & Wines	A - Excellent			Magnesium Carbonate	A - Excellent			Xylene	A - Excellent			Magnesium Chloride	A2 - Excellent				
CHEMICAL	COMPATIBILITY	CHEMICAL	COMPATIBILITY	CHEMICAL	COMPATIBILITY	CHEMICAL	COMPATIBILITY	CHEMICAL	COMPATIBILITY	CHEMICAL	COMPATIBILITY																																																																																																																																																																																																																																																																																																																																																																																																																																				
Acetic Acid	A - Excellent	Carbon Dioxide (wet)	A - Excellent	Magnesium Hydroxide	A - Excellent	Propylene Glycol	A - Excellent																																																																																																																																																																																																																																																																																																																																																																																																																																								
Acetic Acid 20%	A - Excellent	Carbon Tetrachloride	A - Excellent	Magnesium Nitrate	A - Excellent	Pyridine	A - Excellent																																																																																																																																																																																																																																																																																																																																																																																																																																								
Acetic Acid 80%	A - Excellent	Carbon Tetrachloride (dry)	A - Excellent	Manganese Sulfate	A - Excellent	Saag Solutions	A - Excellent																																																																																																																																																																																																																																																																																																																																																																																																																																								
Acetic Acid, Glycerol	A - Excellent	Carbon tetrachloride (wet)	A - Excellent	Mercuric Chloride (dilute)	A - Excellent	Sodium Acetate	A - Excellent																																																																																																																																																																																																																																																																																																																																																																																																																																								
Acetic Anhydride	A - Excellent	Chloroform	A - Excellent	Mercuric Cyanide	A - Excellent	Sodium Bicarbonate	A - Excellent																																																																																																																																																																																																																																																																																																																																																																																																																																								
Acetone	A - Excellent	Chlorine Water	A - Excellent	Mercurous Nitrate	A - Excellent	Sodium Bisulfite	A - Excellent																																																																																																																																																																																																																																																																																																																																																																																																																																								
Alcohols: Amyl	A - Excellent	Chlorobenzene (Mono)	A - Excellent	Mercury	A - Excellent	Sodium Bisulfate	A - Excellent																																																																																																																																																																																																																																																																																																																																																																																																																																								
Alcohols: Benzyl	A - Excellent	Chlorobromomethane	A - Excellent	Methanol (Methyl Alcohol)	A - Excellent	Sodium Borate (borax)	A - Excellent																																																																																																																																																																																																																																																																																																																																																																																																																																								
Alcohols: Butyl	A - Excellent	Chloroform	A - Excellent	Methyl Alcohol 10%	A - Excellent	Sodium Carbonate	A - Excellent																																																																																																																																																																																																																																																																																																																																																																																																																																								
Alcohols: Ethyl	A - Excellent	Chlorosulfonic Acid	A - Excellent	Methyl Ethyl ketone	A - Excellent	Sodium Chloride	A - Excellent																																																																																																																																																																																																																																																																																																																																																																																																																																								
Alcohols: Isopropyl	A - Excellent	Citronic Acid 10%	A - Excellent	Milk	A - Excellent	Sodium Chloride	A - Excellent																																																																																																																																																																																																																																																																																																																																																																																																																																								
Alcohols: Methyl	A - Excellent	Citronic Acid 30%	A - Excellent	Molasses	A - Excellent	Sodium Cyanide	A - Excellent																																																																																																																																																																																																																																																																																																																																																																																																																																								
Alcohols: Propyl	A - Excellent	Citronic Acid 50%	A - Excellent	Motor oil	A - Excellent	Sodium Ferricyanide	A - Excellent																																																																																																																																																																																																																																																																																																																																																																																																																																								
Aluminum Chloride	A - Excellent	Citric Acid	A - Excellent	Naphthalene	A - Excellent	Sodium Fluoride	A - Excellent																																																																																																																																																																																																																																																																																																																																																																																																																																								
Aluminum Chloride 20%	A - Excellent	Cider	A - Excellent	Nickel Chloride	A - Excellent	Sodium Hydroxide (20%)	A - Excellent																																																																																																																																																																																																																																																																																																																																																																																																																																								
Aluminum Sulfate	A - Excellent	Citric Acid 50%	A - Excellent	Nickel Nitrate	A - Excellent	Sodium Hydroxide (50%)	A - Excellent																																																																																																																																																																																																																																																																																																																																																																																																																																								
Ammonia 10%	A - Excellent	Copper Chloride	A - Excellent	Nickel Sulfate	A - Excellent	Sodium Hydroxide (80%)	A - Excellent																																																																																																																																																																																																																																																																																																																																																																																																																																								
Ammonia liquid	A - Excellent	Copper Oxide	A - Excellent	Nitric Acid (20%)	A - Excellent	Sodium Hypochlorite (<20%)	A - Excellent																																																																																																																																																																																																																																																																																																																																																																																																																																								
Ammonium Carbonate	A - Excellent	Copper Nitrate	A - Excellent	Nitric Acid (50%)	A - Excellent	Sodium Hypochlorite (100%)	A - Excellent																																																																																																																																																																																																																																																																																																																																																																																																																																								
Ammonium Chloride	A - Excellent	Copper Sulfate 5%	A - Excellent	Nitric Acid (6-10%)	A - Excellent	Sodium Nitrate	A - Excellent																																																																																																																																																																																																																																																																																																																																																																																																																																								
Ammonium Hydroxide	A - Excellent	Crotonaldehyde	A - Excellent	Nitric Acid (concentrated)	A - Excellent	Sodium Sulfate	A - Excellent																																																																																																																																																																																																																																																																																																																																																																																																																																								
Ammonium Nitrate	A - Excellent	Dietergents	A - Excellent	Oil: Castor	A - Excellent	Sodium Sulfate	A - Excellent																																																																																																																																																																																																																																																																																																																																																																																																																																								
Ammonium Persulfate	A - Excellent	Dichloroethane	A - Excellent	Oil: Cottonseed	A - Excellent	Sodium Sulfide	A - Excellent																																																																																																																																																																																																																																																																																																																																																																																																																																								
Ammonium Sulfate	A - Excellent	Ethanol	A - Excellent	Oil: Linseed	A - Excellent	Stannic Chloride	A - Excellent																																																																																																																																																																																																																																																																																																																																																																																																																																								
Amyl Acetate	A - Excellent	Ethanolamine	A - Excellent	Oil: Mineral	A - Excellent	Starch	A - Excellent																																																																																																																																																																																																																																																																																																																																																																																																																																								
Amyl Alcohol	A - Excellent	Ethyl Acetate	A - Excellent	Oil: Olive	A - Excellent	Sulfuric Acid (<10%)	A - Excellent																																																																																																																																																																																																																																																																																																																																																																																																																																								
Aniline	A - Excellent	Ethyl Chloride	A - Excellent	Oleic Acid	A - Excellent	Sulfuric Acid (10-25%)	A - Excellent																																																																																																																																																																																																																																																																																																																																																																																																																																								
Antimony Trichloride	A - Excellent	Ethylene Dichloride	A - Excellent	Oxalic Acid (cold)	A - Excellent	Sulfuric Acid (75-100%)	A - Excellent																																																																																																																																																																																																																																																																																																																																																																																																																																								
Antimony Trichloride	B - Good	Ethylene Glycol	A - Excellent	Paraffin	A - Excellent	Sulfuric Acid (hot concentrated)	A - Excellent																																																																																																																																																																																																																																																																																																																																																																																																																																								
Barium Carbonate	A - Excellent	Fatty Acids	A - Excellent	Perchloroethylene	A - Excellent	Tannic Acid	A - Excellent																																																																																																																																																																																																																																																																																																																																																																																																																																								
Barium Chloride	A - Excellent	Ferric Sulfate	A - Excellent	Phenol (10%)	A - Excellent	Tartaric Acid	A - Excellent																																																																																																																																																																																																																																																																																																																																																																																																																																								
Barium Chloride	A - Excellent	Ferrous Sulfate	A - Excellent	Phenol (Carbolic Acid)	A - Excellent	Tertbutyl Alcohol	A - Excellent																																																																																																																																																																																																																																																																																																																																																																																																																																								
Barium Hydroxide	A - Excellent	Ferrous Sulfate	A - Excellent	Phosphoric Acid (<30%)	A - Excellent	Tetralin	A - Excellent																																																																																																																																																																																																																																																																																																																																																																																																																																								
Barium Sulfate	A - Excellent	Freon 113	A - Excellent	Phosphoric Acid (>30%)	A - Excellent	Toluene (Toluol)	A - Excellent																																																																																																																																																																																																																																																																																																																																																																																																																																								
Barium Sulfide	A - Excellent	Freon TF	A - Excellent	Phosphoric Acid (>90%)	A - Excellent	Trichloroethylene	A - Excellent																																																																																																																																																																																																																																																																																																																																																																																																																																								
Benzaldehyde	A - Excellent	Freon 11	A - Excellent	Phosphoric Acid (>90%)	A - Excellent	Triethyleneglycol	A - Excellent																																																																																																																																																																																																																																																																																																																																																																																																																																								
Benzene	A - Excellent	Fruit Juice	A - Excellent	Phosphoric Acid (>90%)	A - Excellent	Trimethylamine	A - Excellent																																																																																																																																																																																																																																																																																																																																																																																																																																								
Benzene Sulfonic Acid	A - Excellent	Gasoline (High aromatic)	A - Excellent	Phosphoric Acid (>90%)	A - Excellent	Tripropylene Glycol	A - Excellent																																																																																																																																																																																																																																																																																																																																																																																																																																								
Benzonic Acid	A - Excellent	Gasoline, leaded, ref	A - Excellent	Phosphoric Acid (>90%)	A - Excellent	Urea	B - Good																																																																																																																																																																																																																																																																																																																																																																																																																																								
Benzol	A - Excellent	Glycerin	A - Excellent	Phosphoric Acid (>90%)	A - Excellent	Vegetable Juice	A - Excellent																																																																																																																																																																																																																																																																																																																																																																																																																																								
Boric Acid	A - Excellent	Hydrogen Peroxide 100%	A - Excellent	Phosphoric Acid (>90%)	A - Excellent	Vinagar	A - Excellent																																																																																																																																																																																																																																																																																																																																																																																																																																								
Bromine	A - Excellent	Hydrogen Sulfide (aque)	A - Excellent	Phosphoric Acid (>90%)	A - Excellent	Vinyl Acetate	A - Excellent																																																																																																																																																																																																																																																																																																																																																																																																																																								
Calcium Carbonate	A - Excellent	Ink	A - Excellent	Phosphoric Acid (>90%)	A - Excellent	Vinyl Chloride	B - Good																																																																																																																																																																																																																																																																																																																																																																																																																																								
Calcium Chloride	A - Excellent	Kerosene	A - Excellent	Phosphoric Acid (>90%)	A - Excellent	Water Acid Mine	A - Excellent																																																																																																																																																																																																																																																																																																																																																																																																																																								
Calcium Hydroxide	A - Excellent	Lactic Acid	A - Excellent	Phosphoric Acid (>90%)	A - Excellent	Water/ Deionized	B - Good																																																																																																																																																																																																																																																																																																																																																																																																																																								
Calcium Hydrochloride	A - Excellent	Lead Acetate	A - Excellent	Phosphoric Acid (>90%)	A - Excellent	Water/ Fresh	A - Excellent																																																																																																																																																																																																																																																																																																																																																																																																																																								
Calcium Nitrate	A - Excellent	LiAlH ₄	A - Excellent	Phosphoric Acid (>90%)	A - Excellent	Water/ Salt	B - Good																																																																																																																																																																																																																																																																																																																																																																																																																																								
Calcium Sulfate	A - Excellent	Lye: Ca(OH) ₂ Calcium Hydroxide	A - Excellent	Phosphoric Acid (>90%)	A - Excellent	Wheat Killers	B - Good																																																																																																																																																																																																																																																																																																																																																																																																																																								
Carbolic Acid (Phenol)	A - Excellent	Lye: NaOH Sodium Hydroxide	A - Excellent	Phosphoric Acid (>90%)	A - Excellent	Whiskey & Wines	A - Excellent																																																																																																																																																																																																																																																																																																																																																																																																																																								
		Magnesium Carbonate	A - Excellent			Xylene	A - Excellent																																																																																																																																																																																																																																																																																																																																																																																																																																								
		Magnesium Chloride	A2 - Excellent																																																																																																																																																																																																																																																																																																																																																																																																																																												

Ratings - Chemical Effect
A - Excellent
B - Good: Minor Effect, slight corrosion, or discoloration.

ELECTRONSYSTEM MD S.r.l.

Prep. **C. FORLANI**

Dis. **P. QUIZZETTI**

App. **P. QUIZZETTI**

First Issue: _____

NOTE: _____

Resp. Dep. **Technical Dept.**

Uff. Resp. _____

Title **SGM type A analog absolute**

Approv. **pressure sensor**

Doc. No. **43931104**

Scale **1:1**

Scale **R_P 5**

All specs are subject to change without notice

Gas/Oil absolute pressure transmitter

STORAGE

If the complex must be storage before use, please keep dry and repaired.

Do not leave outdoor.

Device is strongly sensitive to humidity hence avoid to store where relative humidity is more than 90%

STORAGE TEMPERATURE: $-30^{\circ}\text{C} \div +70^{\circ}\text{C}$

RELATIVE HUMIDITY: max 90% @ $+40^{\circ}\text{C}$

MAINTENANCE

Maintenance of transmitter must be done compulsory in factory. We recommend every 5 years to send back transmitter for calibration check and inspection.

WARRANTY

Device is covered by 24 months after installation or max 36 months after delivery.

In case of service the transmitter must be sent back to factory for inspection.

Gas/Oil absolute pressure transmitter**WARNINGS****CAUTION**

Do not drop or hit the transmitter. The sensor is fragile and may break from sudden shock. When transporting the transmitter, use the original shipping box from Electronsistem MD.

NOTE

Keep the transmitter dry and clean.

Do not remove the transparent transport protection caps before you are ready to install the transmitter.

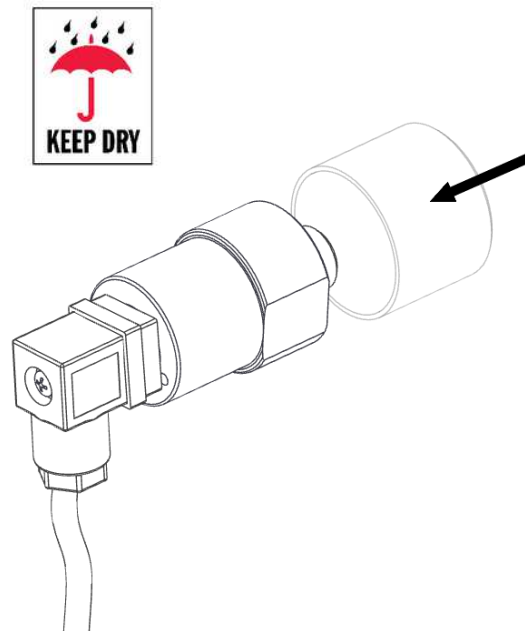
**NOTE**

Connect the transmitter directly to the main gas volume, not behind a sampling line because this is the area where high humidity tends to accumulate and where the temperature of gas is not the imagine of gas near breaker.

The use of original cable wiring is advised to have the better protection performances.

Gas/Oil absolute pressure transmitter**INSTALLATION**

1. Remove the transparent transport cap when you are ready to install the transmitter. Check o-ring is clean without dust and properly assembled.

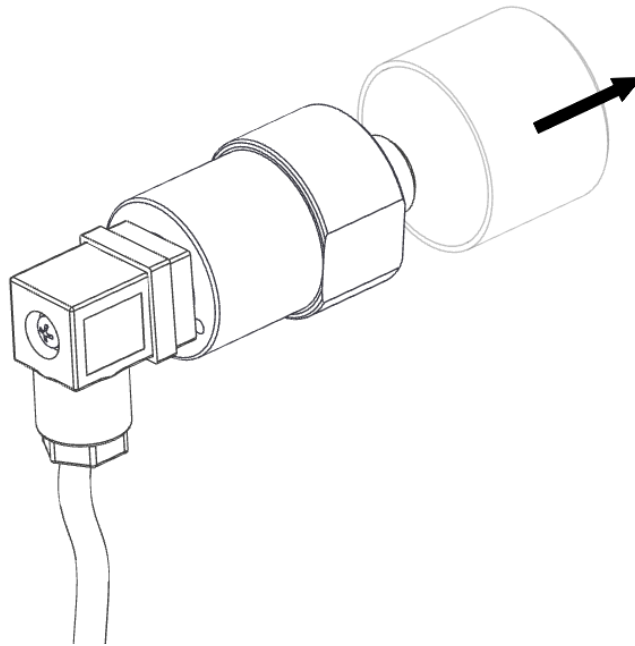

All specs are subject to change without notice

Gas/Oil absolute pressure transmitter

2. Install the transmitter to the mechanical coupling and tighten gently by hand. Then use a 27mm wrench to tighten the connection. Use a sufficient force to achieve a tight installation (recommended 10-15Nm) . The system must be leak-free for accurate measurement.

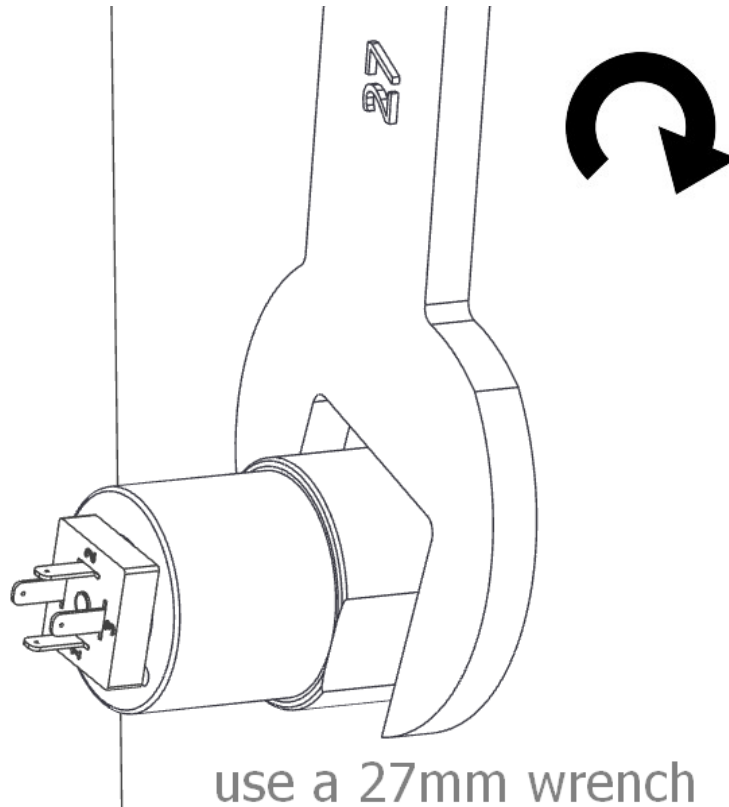

All specs are subject to change without notice

Gas/Oil absolute pressure transmitter

3. Connect proper wiring into the output port checking the correct polarization of the connector and checking the presence of the squared seal.

Then insert the screw supplied and tight the screw with a screwdriver

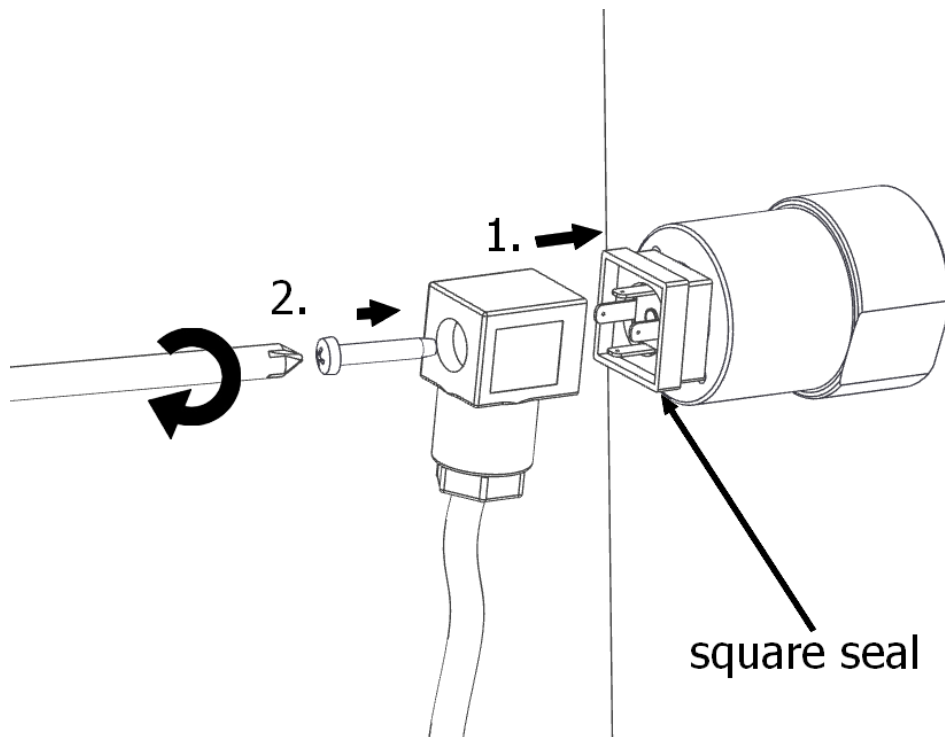

Gas/Oil absolute pressure transmitter

DISCLAIMER NOTE:

While we provide application assistance it is up to the customer to determine the suitability for its use.

Specification may change without notice. The information we supply is believed to be accurate and reliable as of this printing. However we assume no responsibility for its use.

The quality of ElectronsystemMD products is guaranteed by a Quality, Safety and Environmental management system certified by DNV according to ISO 9001, ISO 18001 and ISO 14001. Electronsystem MD works in partnership with its customers in designing customized executions in order to meet specific requirements, please contact us.

All specs are subject to change without notice